

Wichita Stamp Club Newsletter



Vol. 82, No. 9, September, 2014

Neal E. Danielson
Editor



"Go Fly A Stamp"



Click on a link below in order to go directly to the article.

[Don't Sweat the Small Stuff](#)

Another little number in a continuing series

[Travel Kansas](#)

A philatelic visit to Sumner County

[Go to WSC Home Page](#)

DON'T SWEAT THE SMALL STUFF by Neal E. Danielson

This was the 59th in a series of articles relating to small post cards and small covers so if you have any in your collection that you would like to share please let us know.



Figure 1
Small Stuff Cover 1946

This Small Stuff comes to you by way of Tulsa, Oklahoma, via Des Moines, Iowa through New York City, New York. This Small Stuff measures 4 inches by 3 inches and is franked with a 3¢ Stephen Watts Kearny Expedition Centennial Entry into Santa Fe stamp (Scott #946) and tied to the cover with two different Slogan Cancellations relating to ‘Savings Bonds’; Tulsa, Oklahoma on Nov. 22, 1946 Slogan “Save The Easy Way Buy U. S. Bonds Through Payroll Savings.” And one from Des Moines on Nov. 25, 1946 Slogan “Build Your Fortune Wisely With U. S. Savings Bonds” (Figure 1). The 3¢ stamp commemorates General Kearny entrance into Santa Fe where he used diplomatic finesse not military action and persuaded the powerful Mexican military to leave Santa Fe during the Mexican War (1846-1848). He would go on to establish a civil government and promised a democratic administration in the area.

The individual in Tulsa, Oklahoma evolved from Indian Territory that was settled by the Lochapoka and Creek tribes in 1836 and called their settlement built under large oak trees in the area, *Tallasi* in Creek language which translated as “old town”, which would eventually become “Tulsa” in 1898. By 1901 Tulsa had their first oil well and by 1905 a large deposit located about 15 miles south resulted in a rush of entrepreneurs setting up shop in the area. Most of the oil was found on land that the Osage Nation owned the mineral rights. Tulsa would become known as “Oil Capital of the World” for most of the 20th century. The oil industry was responsible for the survival of many during the “Great Depression”. The “Father of Route 66”, Tulsa businessman Cyrus Avery began his campaign in 1925 to create the route linking Chicago to California which gave Tulsa the nickname “Birthplace of Route 66”.

The Small Stuff cover was sent to a family in Des Moines, the Capital of the State of Iowa and the County seat of Polk County. The city was incorporated in 1851 as a Fort but was changed to just Des Moines in 1857. Des Moines became known as a major center for the U. S. insurance industry along with a great financial service and publishing businesses. The Fort was constructed in 1843 at the site where the Raccoon and Des Moines Rivers merge, in an effort to control the Sauk and Meskwaki Indians. The Indian tribes did not fare well in the area due to illegal whiskey trade and the lifestyle of the Fort and they were

removed from the area. The Fort was abandoned for a period of time and settlers arrived and occupied the Fort and surrounding area and on May 25, 1846 it became the County Seat of Polk County.

Once the Small Stuff cover arrived in Des Moines someone forwarded the cover on to the Weeks family at the Park Central Hotel in New York City (Figure 2). The Park Central Hotel is located at 870 7th Avenue and 55th Street and occupies a Beaux Arts building dating back to 1927 and is just a block from the famed concert venue Carnegie Hall and within five minutes' walk of Manhattan's world-renowned Broadway theater district. This Hotel was built during the Roaring Twenties was temporary home for entertainers that entertained some of the most influential figures of the day—from Mae West and Jackie Gleason to Glenn Miller, Tommy Dorsey and even First Lady Eleanor Roosevelt stayed and/or were entertained at the luxury Hotel.

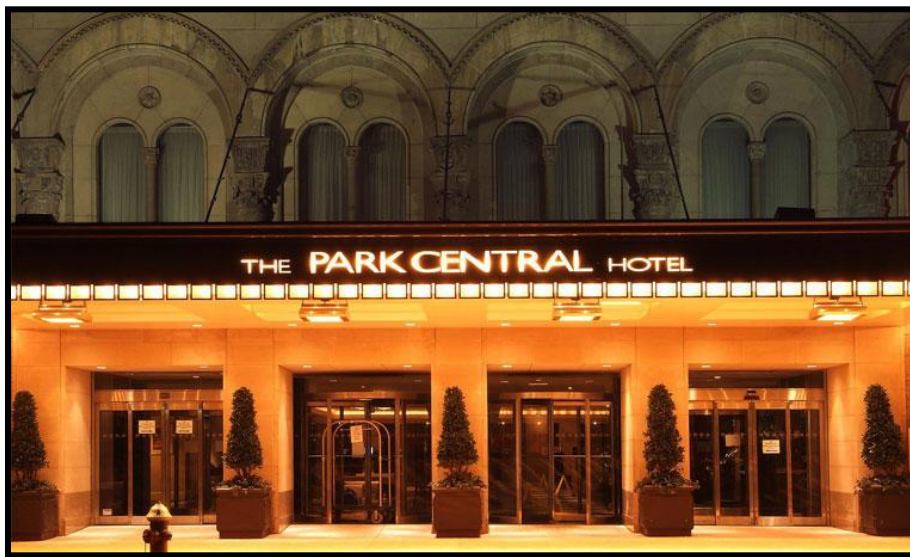

Figure 2
Park Central Hotel Entrance 7th Avenue

[Return to September Contents](#)

[Go to WSC Home Page](#)

SUMNER COUNTY—PART I

EXPLORING EASTERN SUMNER COUNTY by Jeff Lough

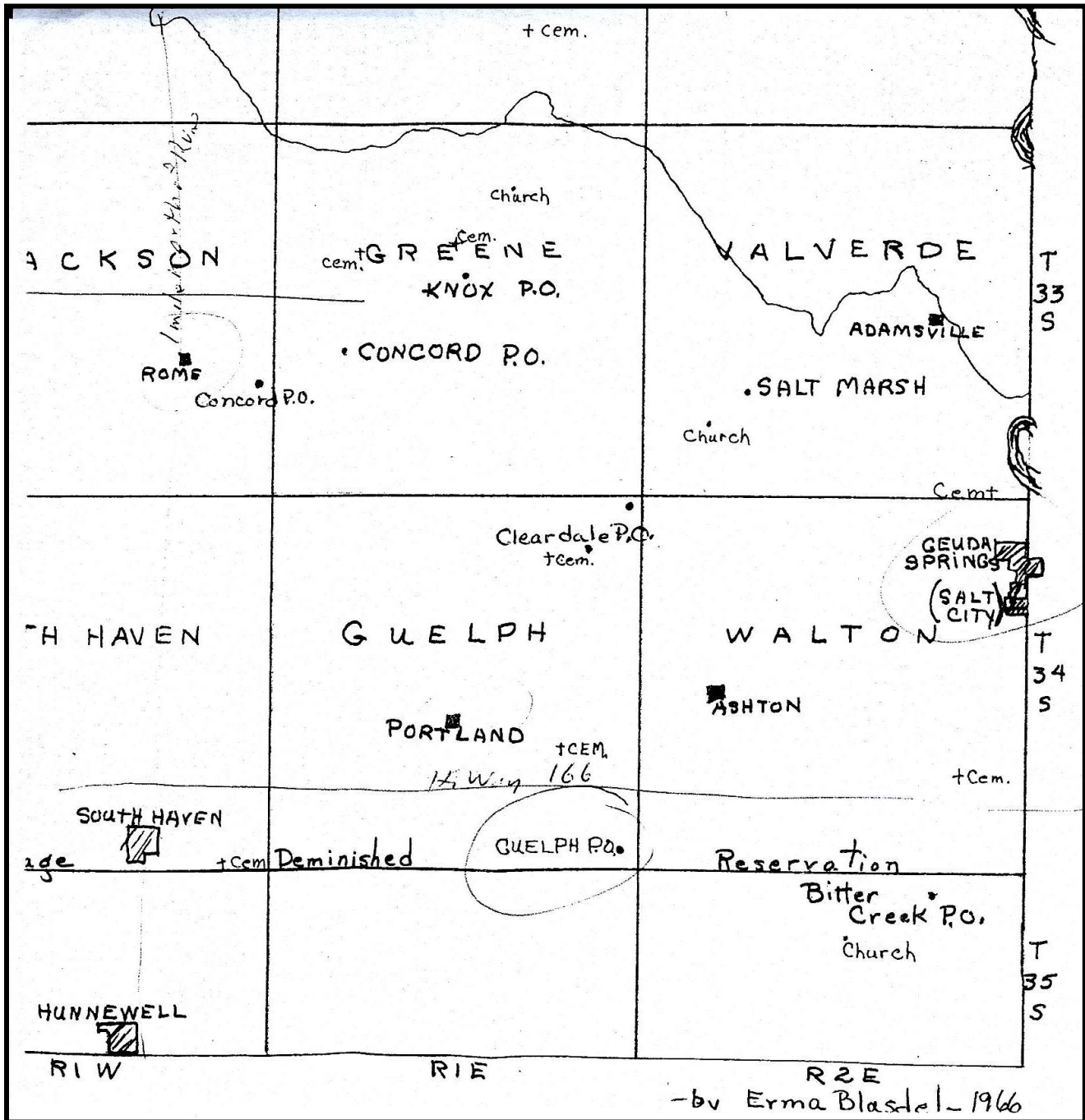

Figure 1
Map of southeastern Sumner County

A major frontier trail and a multitude of railway developments led to the establishment of many post offices and named centers of population in Sumner County Kansas. In 1883 there were 33 post offices in the county. Some of those post offices have some interesting stories to tell.

Several ghost towns and one active bedroom community lie to the far east of the county. They generally began as stops on branches of what became the Santa Fe Railway. In the early days there were many small farmers who raised wild game, domesticated livestock, some crops and picked wild grapes and plums. Recreation played an important part in the social life. There was a horse racing track near Portland and a popular lake north of Gueda Springs. Nowadays the area seems to be principally whole sections of wheat with occasional settlements of families either retired or commuting to Arkansas City, Wellington or Oxford for work. The far south of the county had been a part of the Indian Territory, the "Diminished Osage Reserve" until 1867 when the Kansas State Legislature laid claim to the land and no response from any other party ensued. Please see the accompanying map (Fig. 1) of southeastern Sumner County Kansas to get an idea of the relative locations of these small communities. The townships were intended to be six miles square.

Guelph

Guelph is one of those former population centers that currently exists in no form. It was founded in 1880 and had a store and post office. The accompanying registered cover (Fig. 2) dated October 20, 1897 carries the General Sherman 8 cent stamp (SN 257) on a U313. The town had a workshop to repair railroad equipment, a school, about 30 homes and a couple general stores. The name "Guelph" reportedly comes from Guelph, Canada where an early resident had previously lived. Guelph is currently the middle of a wheat field a little east of the town of South Haven.

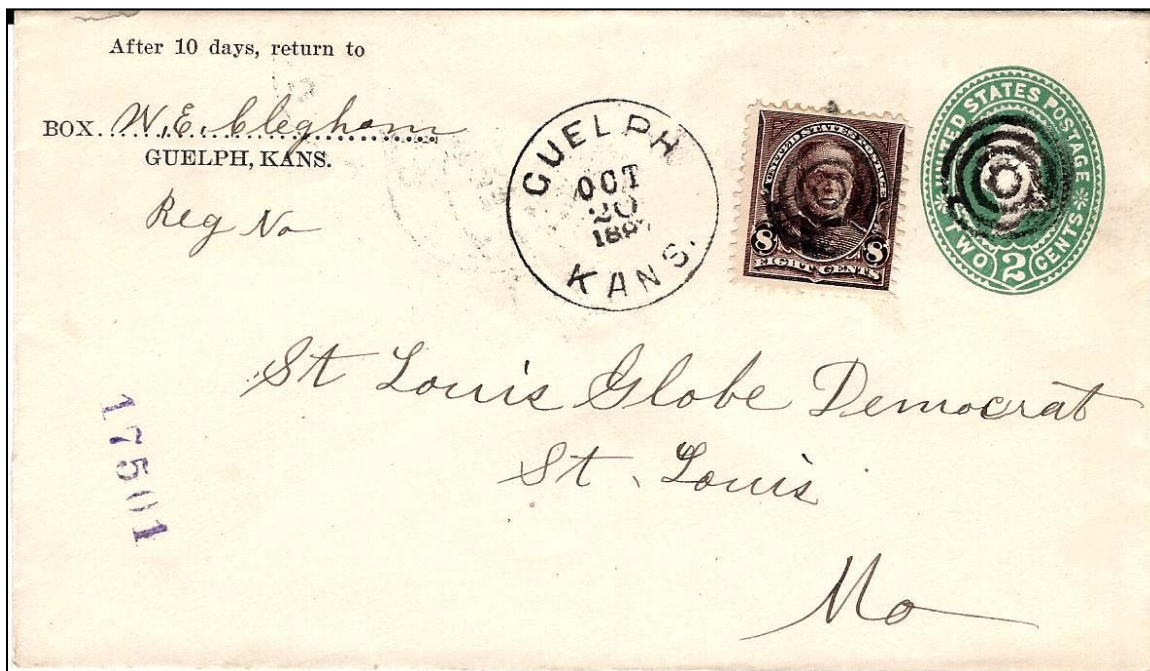

Figure 2
Guelph Cover

Cleardale / Clear Dale

Cleardale was one of the earliest small towns established in Sumner County, founded in 1872. It had a large mercantile, a cooperative store affiliated with the Grange, a blacksmith shop, a millinery store, a physician with his pharmacy, and a school. The accompanying cover (Fig. 3) was sent to a medical concern in Topeka that specialized in distributing home remedies. A bulls eye cancellation on SN 406 completes the cancellation process with a circular date/town postmark. The Cleardale post office was established in 1877 and lasted until 1900. It was located in the mercantile and later in a small store. Samuel Beighler was the first postmaster. No evidence of Cleardale exists at present. It is believed that the location of this community is in a wooded area close to a farm home in east central Sumner County. After the post office closed in Cleardale, local mail was posted through the Dalton post office.

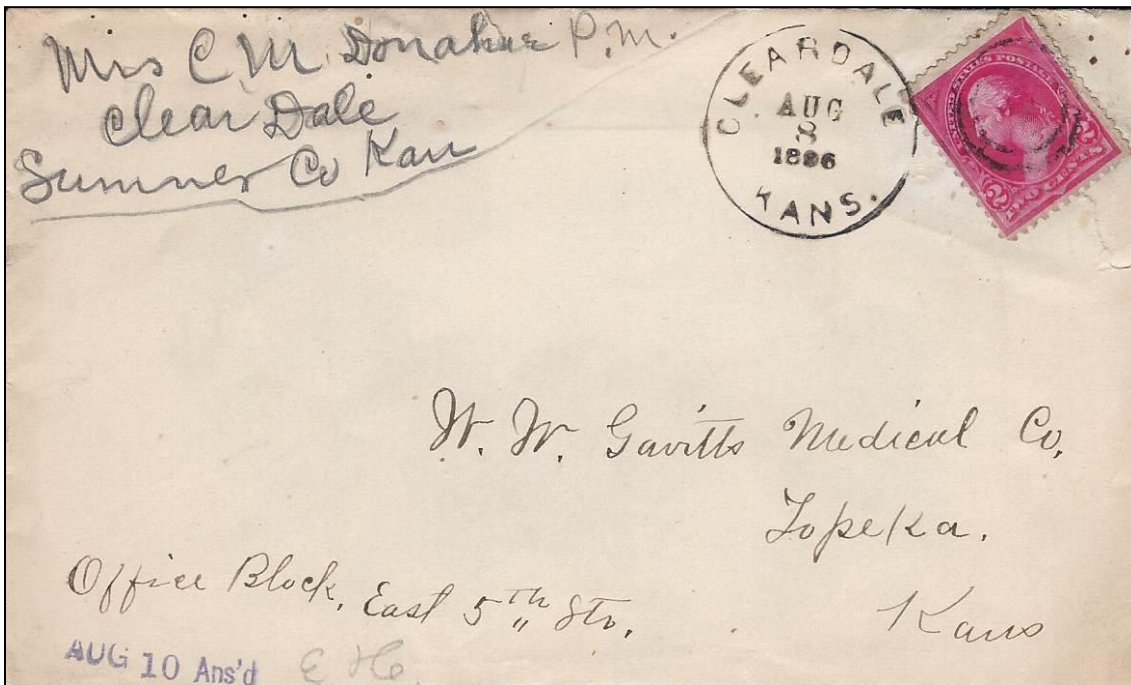

Figure 3
Cleardale Cover 1896

Dalton

Dalton is another ghost town in east central Sumner county. In the early 1800s the town had a bank, hotel, railway depot, two grain elevators, a lumber and hardware store, a school, numerous homes, and two grocery stores. The post office was in one of the grocery stores. It operated from 1885 to 1939. Major George W. Doughty was the first postmaster. Major Doughty arrived in the area in 1884 and purchased 25 acres upon which he laid out a town and put up a residence and store. Figure 4 shows a nice historical cover dated with a classical circular date stamp indicating a mailing of March 19, 1895. A two cent Washington stamp, SN 406, being cancelled by a locally made cork cancelation.



Figure 4
Dalton Cover 1895

Figure 5 shows a philatelically designed cover with U429 cancelled with the last date of operation of the Dalton post office on January 14, 1939 and sent to a locally renowned philatelist, Ira Abildgaard. The Abildgaard family had a hardware store in the city of Oxford, a currently active small town in northeastern Sumner County.

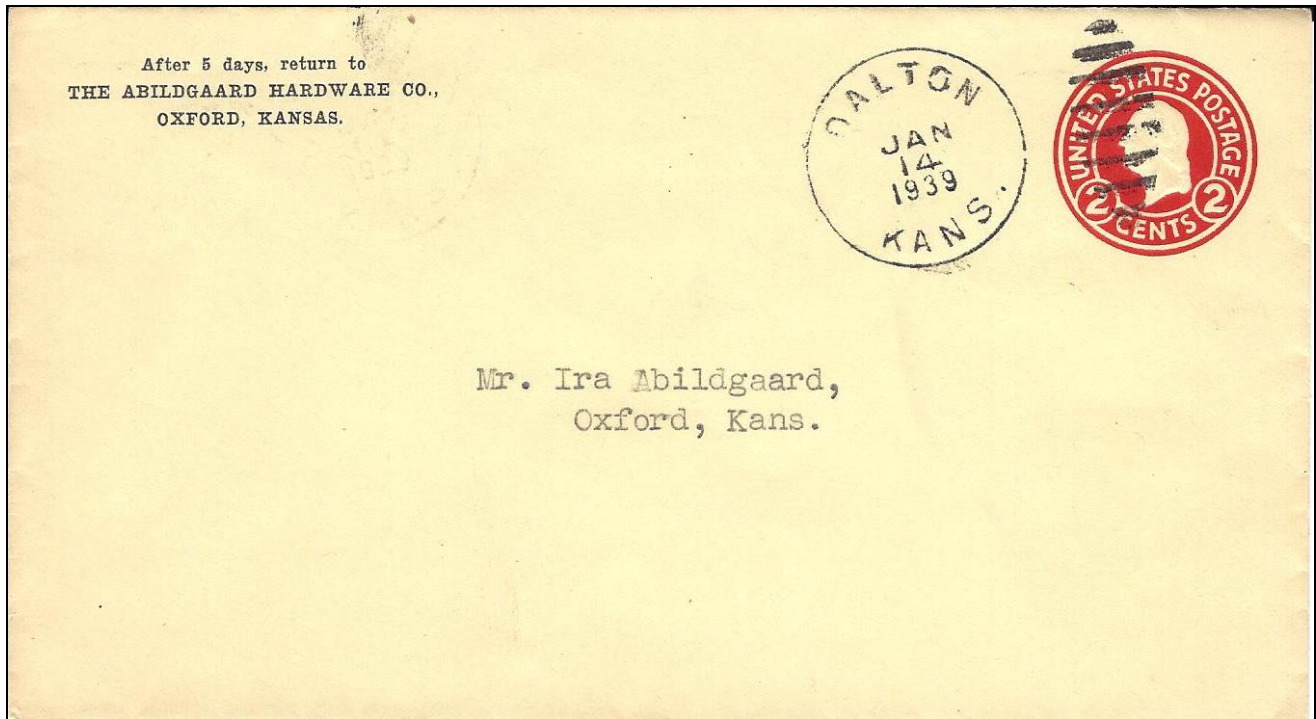

Figure 5
Dalton Cover 1939

Ira Abildgaard was a noted stamp collector who won a gold medal at the August, 1947 53rd annual convention of the Society of Philatelic Americans held in Wichita. The winning exhibit was a collection of the 1862 2 cent Andrew "Black Jack" Jackson stamp. Abildgaard also had collections of Civil War Revenue stamps and Federal Duck Hunting stamps.

“Everyone who has a hobby can tell interesting stories about it. Many times while talking to Mr. Abildgaard he’d remark, ‘There’s quite a long tale connected with this stamp,’ or ‘if you were going to stay the rest of the day I’d tell you the history of this one.’ Even if a person knows little or nothing about stamps a talk with him would convince anyone that there is lots of enjoyment and satisfaction in the stamp collector’s life.”

After the Dalton post office closed some local patrons picked up their mail at the Portland post office.

Portland

Portland was a village located a little north of nearby Guelph. It was originally platted as Hamden, Kansas in 1885 but the name was changed because at that time another town in Kansas had that name. Hamden/Portland had an active 1886 baseball team that played teams representing area towns. The accompanying cover, Figure 6, has a beautiful postmark with a date of September 28, 1887 and a barred barrel killer cancellation on a two cent Washington SN 210. The Portland Post Office operated from May 19, 1886 until Jan. 31, 1940. Portland was a stop on the railroad line between Ark City to the east and Anthony way to the west. The first buildings in Portland had been moved from Rome, which was to the northwest. Portland had a confectionary where candy was made as well as the usual mercantile, church building, and school.



Figure 6
Portland Cover 1887

Railroad cancellation

Figure 7 illustrates a railroad cancellation provided on a Kansas City, Lawrence and South Kansas Railway mobile post office documented with a Route Agent cancel as being near the town of Burden east of the Sumner-Cowley county line. The June 15, 1885 letter from Wellington was addressed to the Commander of the Grand Army of the Republic in Ark City. A simple circular city/date stamp cancels the SN 210 Washington stamp. The KC, L and SK railway became part of the Santa Fe system.

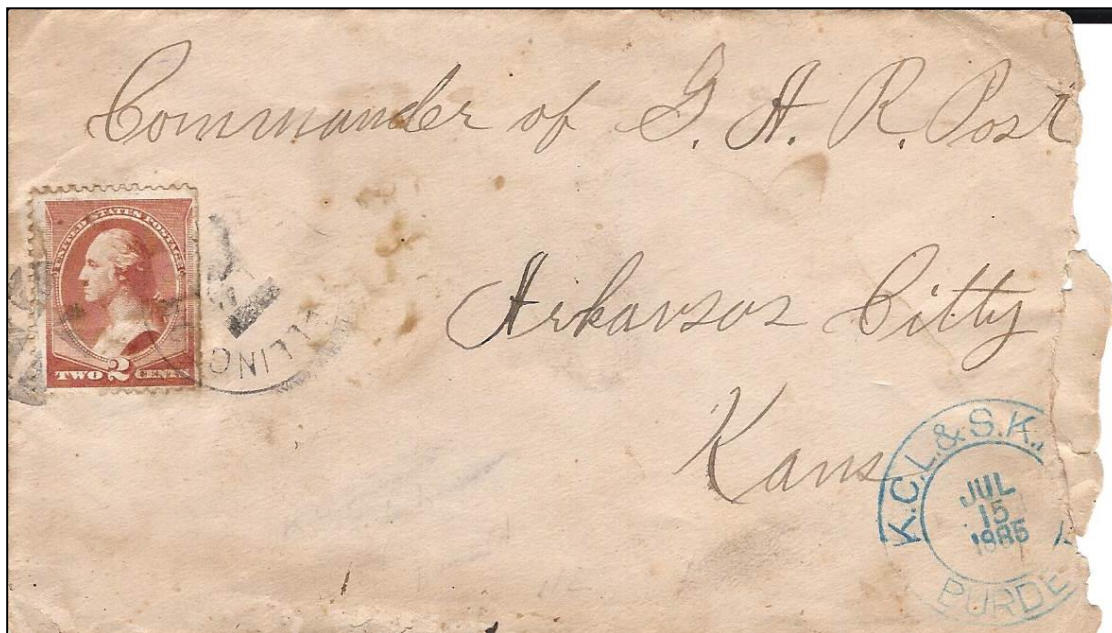

Figure 7
Railroad Cancellation Cover 1885

Salt City/Geuda/Geuda Springs

On the far eastern border of Sumner County the town of Salt City was founded as Remanto in 1872. Remanto had a post office from May 6, 1872 until Oct. 6, 1874 and the postmaster was Orin J. West. Residents preferred "Salt City" and they changed the name in 1874. The post office remained open until July 31, 1885 and the postmaster was Charles C. Stevens. Salt was made from drying the water coming from the nearby springs and marketed to cattlemen passing through as well as to nearby communities. Salt Springs had its own school, baseball team, blacksmith shop, hotel, livery stable and post office. Most of the residents, with their homes and places of business of Salt Springs moved to the Indian Territory when it was opened up to the south in 1889. It is reported that the James Gang used to "hole up" about a mile and a half west of Salt City with some friends. The accompanying January 7th, 1876 cover (Fig. 8) uses a 3 cent Washington SN136 stamp cancelled with probably what was a postmaster provided killer cancel and a simple circular date stamp. The post office operated from 1874-1885.



Figure 8
Salt City Cover

After 1885 the Salt City area and the area immediately north of Salt City was known first as Geuda and then as Geuda Springs. Geuda is believed to have derived its name from a Native American term meaning “healing springs.” The accompanying (Fig. 9) July 2, 1883 cover is very interesting because it has the name of the postmaster printed along with the name of the town and date in the two circle cancellation. A killer using a target cancellation of the three cent Washington SN136 completes the postal workup. Geuda had a post office from June 19, 1882 until January 10, 1900.



Figure 9
Geuda Double Circle Cover



Figure 10
Geuda Springs Bath House

The eight natural springs near Geuda began to be commercially exploited in 1882. A large resort hotel (Fig. 10) was built with covered sheds over several of the springs. It was believed that there were different chemical components in the different springs and that they could treat different ailments. The town's name was changed in 1884 to Geuda Springs. Many visitors came to Geuda Springs on excursion and passenger trains using the Santa Fe rail line passing through town. It is reported that on one Sunday afternoon as many as 900 visitors were in town listening to concerts, boating on the community lake and enjoying the general atmosphere. Geuda Springs had numerous places of business and a school system. About 185 people continue to live in Geuda Springs. The accompanying cover (Fig. 11) bears Andrew Jackson (SN 183) and has a target cancellation with a simple circular postmark containing the name of the community and the date February 18, 1884. It has a fine cachet showing what is likely an artist's rendition of the old hotel. Figure 12 shows a historical plotting plan for the communities of Salt City, Geuda, and Geuda Springs.



Figure 11
Geuda Springs Advertising Cover 1884

[Note: The following Figure 12A & 12B is a Map of Geuda Springs and Salt City—Figure 12A would sit on top of Figure 12B to provide the actual layout of the two communities]

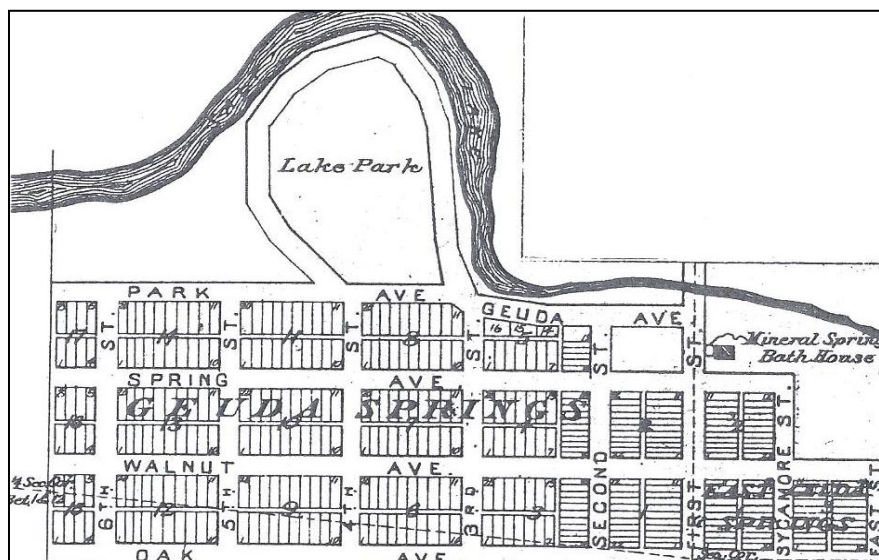

Figure 12A
Map of Geuda Springs & Salt City

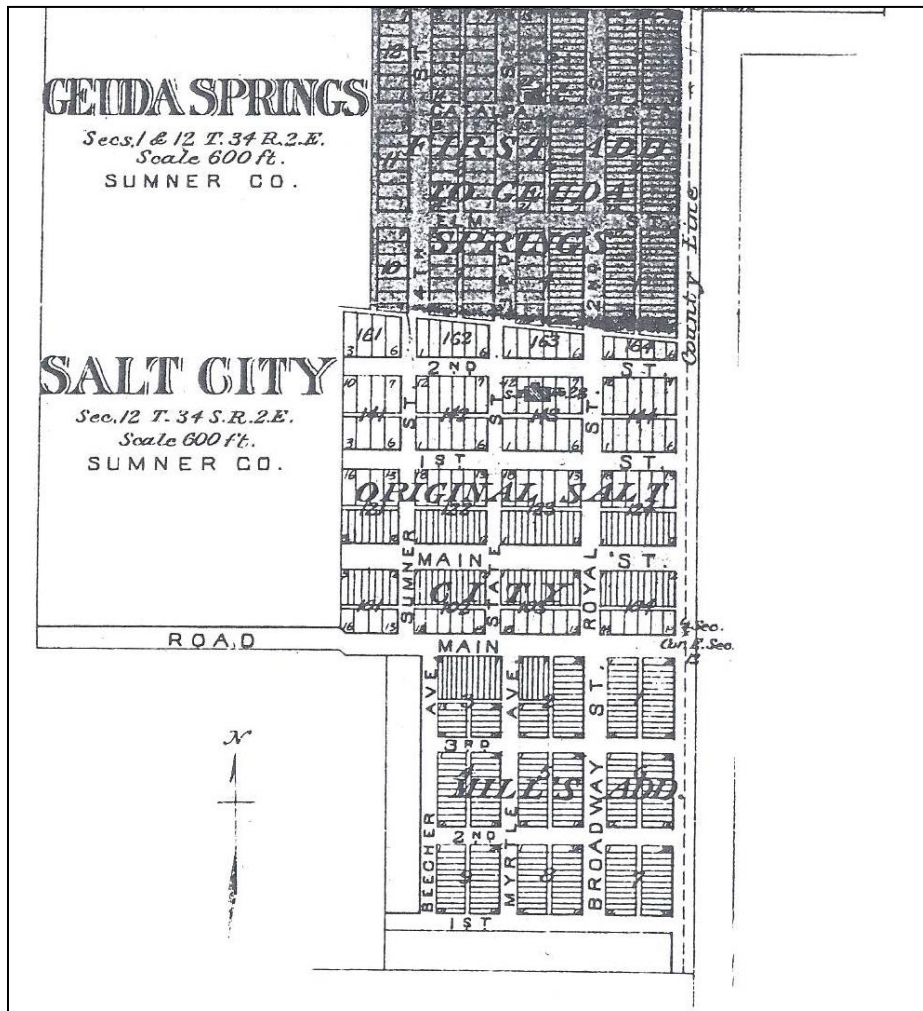

Figure 12B
Map of Gueda Springs & Salt City

Sources

The quote regarding Ira Abildgaard's philatelic life was taken from a collection of undated newspaper clippings published in Oxford, Kansas in 1988.

Edwards, John P. *Historical Atlas of Sumner County Kansas*. Quincy, IL: John P. Edwards, 1883.

Millington D. A. and E. P. Greer. *History of Cowley County Kansas*. Winfield, KS: Winfield Courier, 1901.

Sanders, Gwendoline and Paul. *The Sumner County Story*. North Newton, KS: Mennonite Press, 1966.

PLEASE NOTE: THIS ARTICLE BY JEFF LOUGH ON SUMNER COUNTY WILL SERVE AS THE NORMAL ARTICLE ON "TRAVEL KANSAS" THAT APPEARS MONTHLY IN YOUR NEWSLETTER.

[Return to September Contents](#)

[Go to WSC Home Page](#)